

SIGNING LOCATION GUIDELINE FIGURES

The following are miscellaneous signing figures that were removed from the Standard Drawings. They are provided in this manual as a guideline.

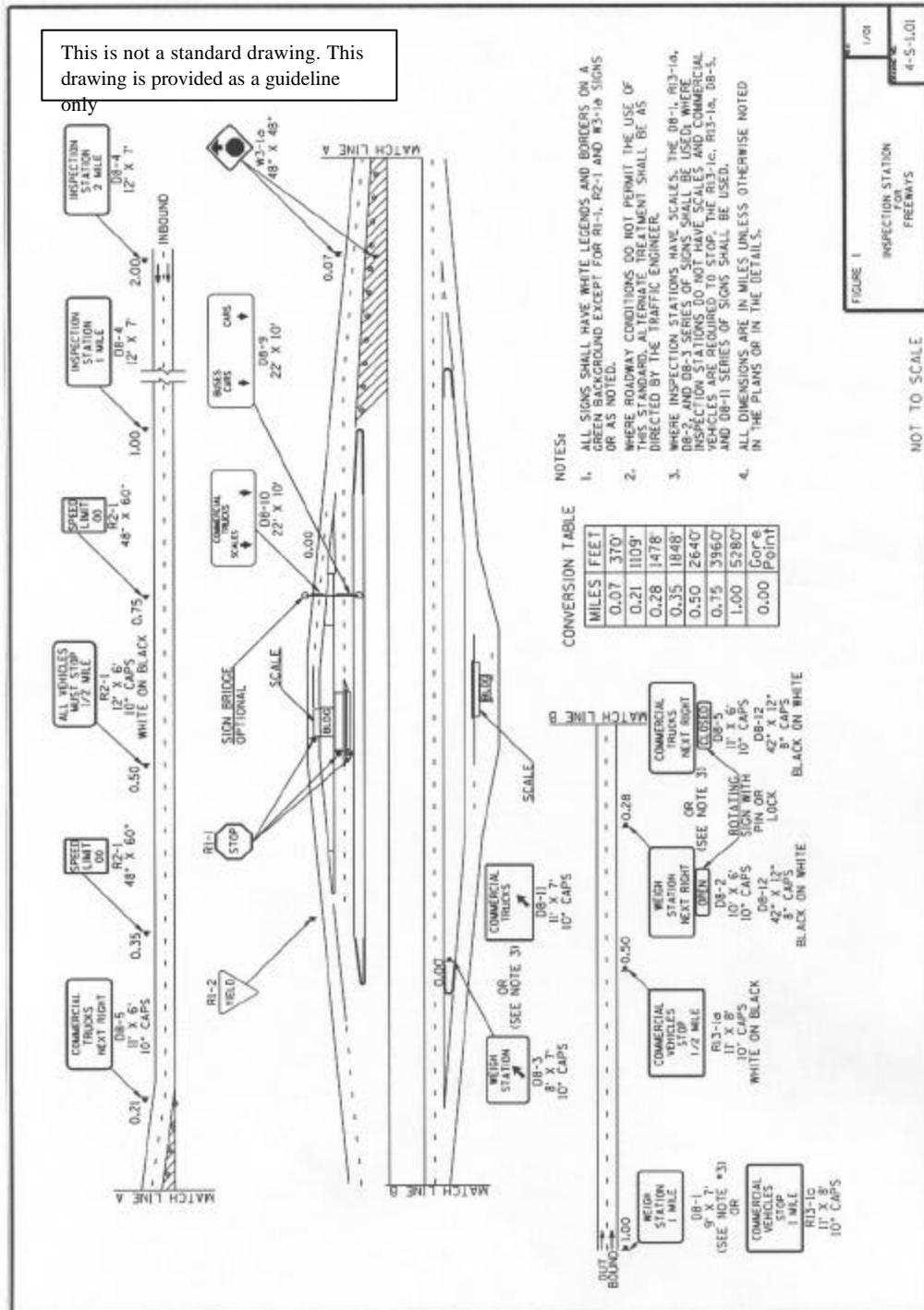

This is not a standard drawing. This drawing is provided as a guideline

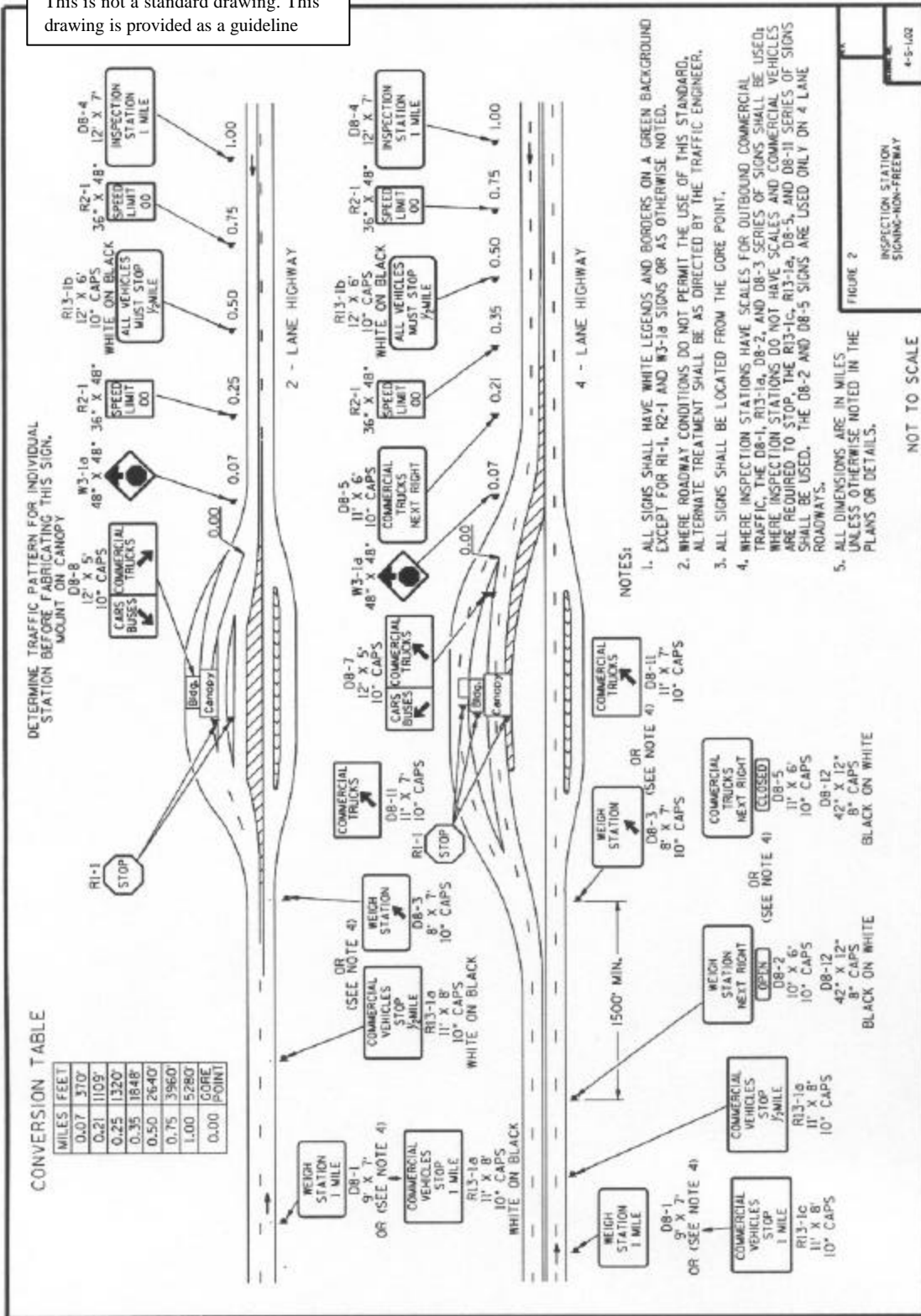

This is not a standard drawing. This drawing is provided as a guideline

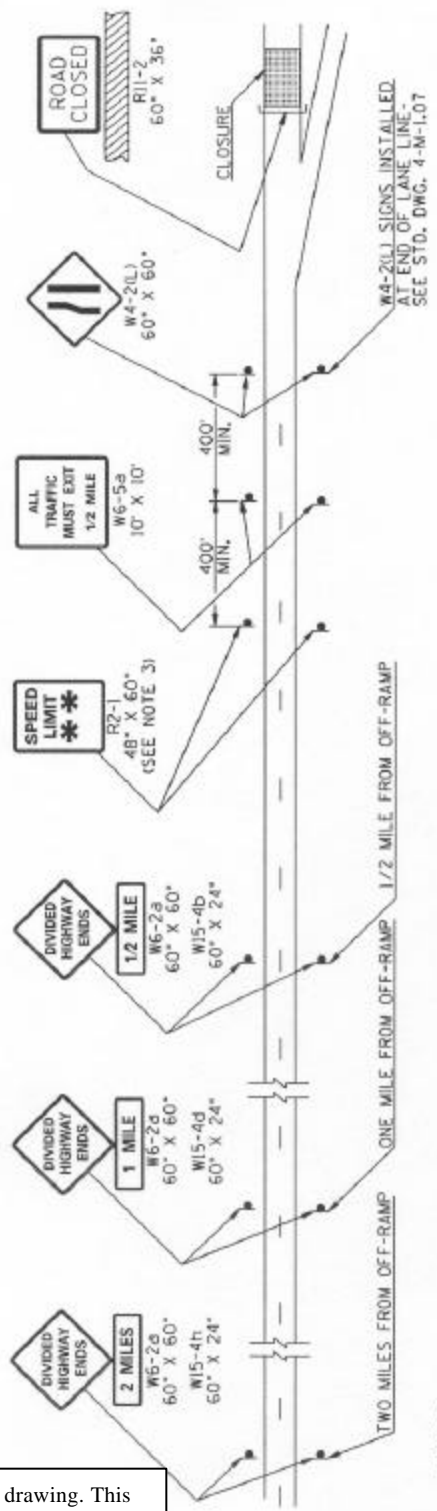

NOTES:

1. WHERE ROADWAY CONDITIONS DO NOT PERMIT THE USE OF THIS STANDARD, ALTERNATE TREATMENT SHALL BE AS DIRECTED BY THE TRAFFIC ENGINEER.
2. DESTINATION SIGNING, ROUTE MARKERS AND OTHER NON-ESSENTIAL SIGNS NOT A PART OF THIS STANDARD, SHOULD NOT BE INSTALLED WITHIN ONE MILE OF THE TRANSITION.
3. THE TRAFFIC ENGINEER WILL DETERMINE THE APPROPRIATE SPEED LIMITS TO BE SHOWN ON R2-1 SIGNS.
4. FOR STRIPING AND DELINEATION FOR FREEWAY TERMINALS, SEE STD. DWG. 4-M-1.07.
5. IF SPEED IS REDUCED MORE THAN 15 MPH, REDUCED SPEED AHEAD SIGNS ARE REQUIRED.
6. ALL DIMENSIONS ARE IN INCHES UNLESS OTHERWISE NOTED IN THE PLANS OR DETAILS.

FIGURE 3
TRANSITION STATION SIGNING
FOR
FREEWAY TERMINALS
1/02
4-5-1.03

NOT TO SCALE

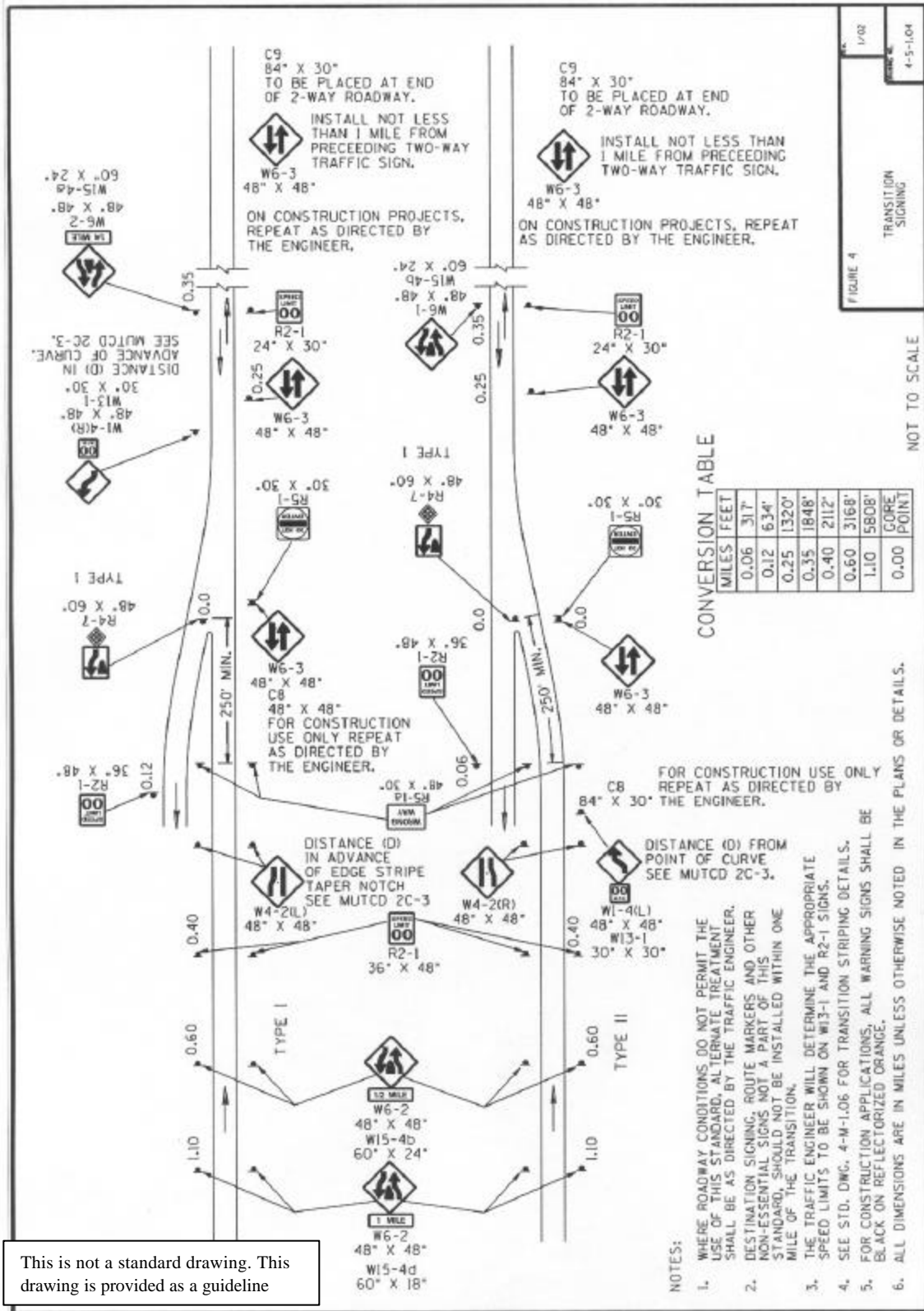

This is not a standard drawing. This drawing is provided as a guideline

- NOTES:
1. WHERE ROADWAY CONDITIONS DO NOT PERMIT THE USE OF THIS STANDARD, ALTERNATE TREATMENT SHALL BE AS DIRECTED BY THE TRAFFIC ENGINEER.
 2. DESTINATION SIGNING, ROUTE MARKERS AND OTHER NON-ESSENTIAL SIGNS NOT A PART OF THIS STANDARD, SHOULD NOT BE INSTALLED WITHIN ONE MILE OF THE TRANSITION.
 3. THE TRAFFIC ENGINEER WILL DETERMINE THE APPROPRIATE SPEED LIMITS TO BE SHOWN ON W13-1 AND R2-1 SIGNS.
 4. SEE STD. DMC. 4-M-1.06 FOR TRANSITION STRIPING DETAILS.
 5. FOR CONSTRUCTION APPLICATIONS, ALL WARNING SIGNS SHALL BE BLACK ON REFLECTORIZED ORANGE.
 6. ALL DIMENSIONS ARE IN MILES UNLESS OTHERWISE NOTED IN THE PLANS OR DETAILS.

CONVERSION TABLE

MILES	FEET
0.06	317'
0.12	634'
0.25	1320'
0.35	1848'
0.40	2112'
0.60	3168'
1.10	5808'
0.00	CORE POINT

FIGURE 4
TRANSITION SIGNING
4-5-1.04

NOT TO SCALE

This is not a standard drawing. This drawing is provided as a guideline

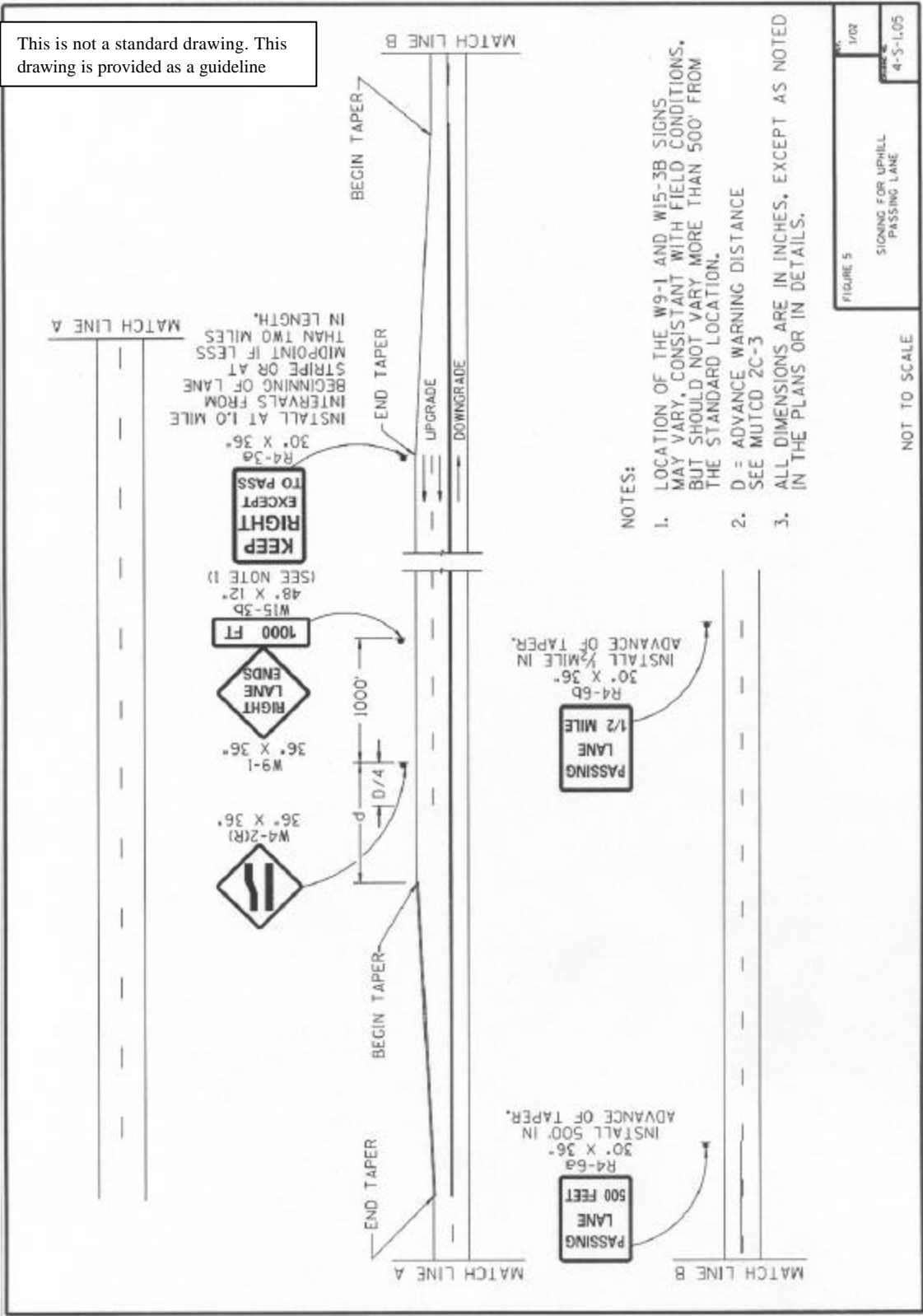

NOTES:

1. LOCATION OF THE W9-1 AND W15-3B SIGNS MAY VARY, CONSISTANT WITH FIELD CONDITIONS, BUT SHOULD NOT VARY MORE THAN 500' FROM THE STANDARD LOCATION.
2. D = ADVANCE WARNING DISTANCE SEE MUTCD 2C-3
3. ALL DIMENSIONS ARE IN INCHES, EXCEPT AS NOTED IN THE PLANS OR IN DETAILS.

FIGURE 5
SIGNING FOR UPHILL PASSING LANE
4-S-1.05

NOT TO SCALE

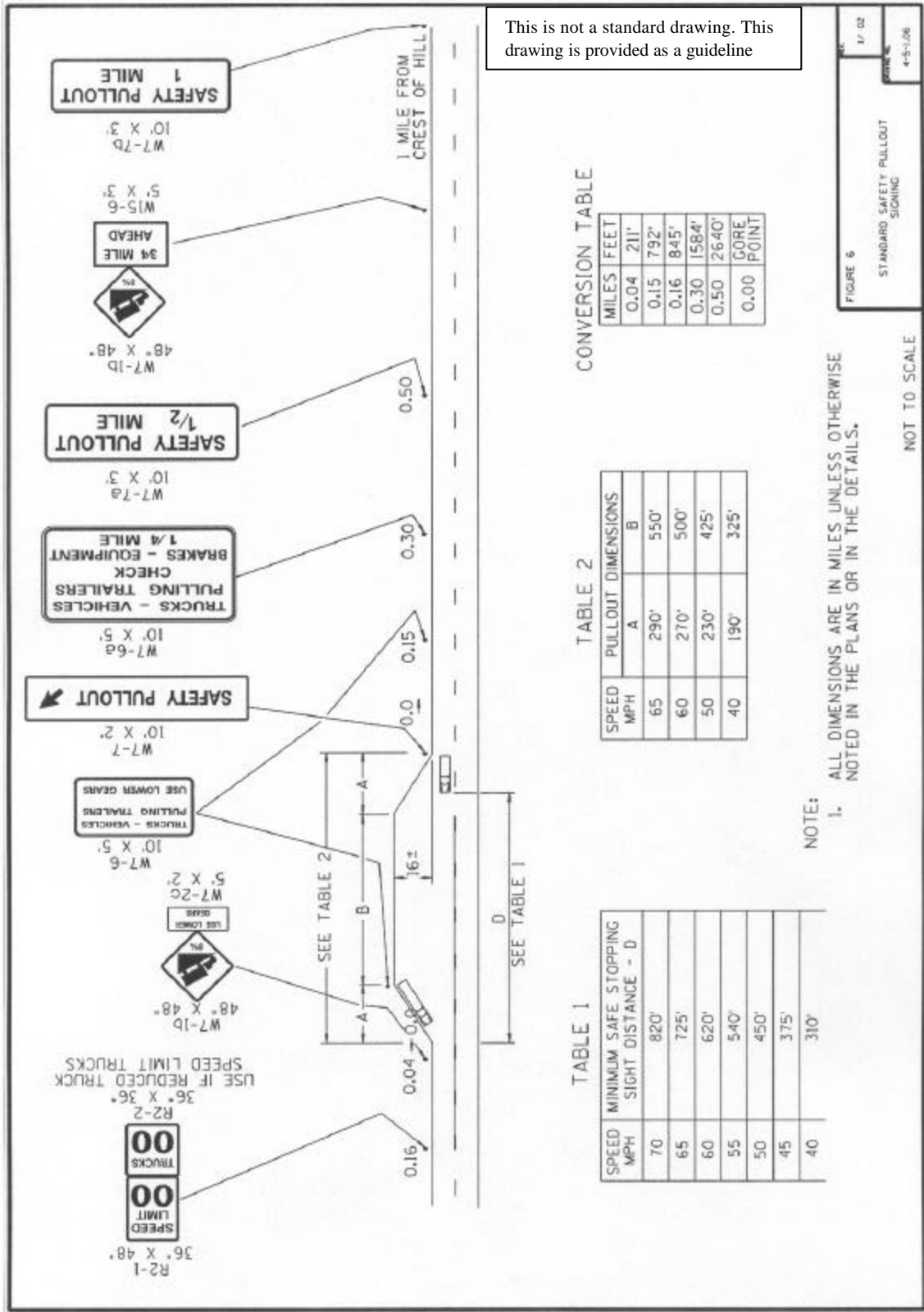

This is not a standard drawing. This drawing is provided as a guideline

TABLE 1

SPEED MPH	MINIMUM SAFE STOPPING SIGHT DISTANCE - D
70	820'
65	725'
60	620'
55	540'
50	450'
45	375'
40	310'

TABLE 2

SPEED MPH	PULLOUT DIMENSIONS	
	A	B
65	290'	550'
60	270'	500'
50	230'	425'
40	190'	325'

CONVERSION TABLE

MILES	FEET
0.04	211'
0.15	792'
0.16	845'
0.30	1584'
0.50	2640'
0.00	CORE POINT

NOTE:
1. ALL DIMENSIONS ARE IN MILES UNLESS OTHERWISE NOTED IN THE PLANS OR IN THE DETAILS.

FIGURE 6
STANDARD SAFETY PULLOUT SIGNING
4-5-106

NOT TO SCALE

LEGEND

R1-1	STOP	42" x 42"	W2-8	36" x 36"	
R1-2		36" x 36" x 36"	W3-1a	36" x 36"	
R2-1		36" x 48"	W3-2a	36" x 36"	
R2-5a		36" x 48"	W4-1	30" x 30"	
R3-1		24" x 24"	W6-2	36" x 36"	
R3-2		24" x 24"	W6-3	30" x 30"	
R4-7		24" x 30"	W13-1	24" x 24"	
R5-1		30" x 30"	W13-2	48" x 60"	
R5-1a		36" x 24"	W13-3	48" x 60"	
R6-1		36" x 12"	Typical Pavement		
W1-1		30" x 30"	Arrows		
W1-2		30" x 30"			
W1-6		60" x 30"			
W1-8		18" x 24"			

Z Red Delineators install if required

This is not a standard drawing. This drawing is provided as a guideline

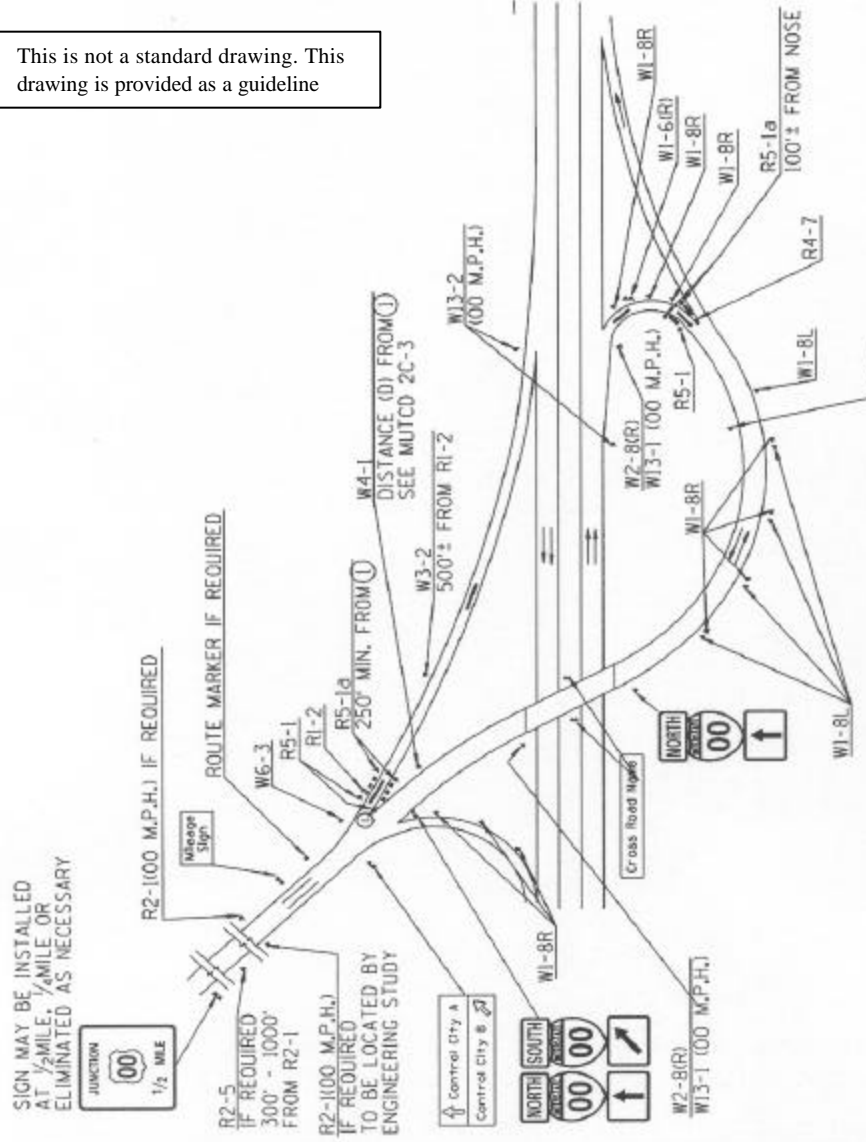

- NOTES:
1. THE SIGNS SHOWN ON THIS SHEET ARE TO BE USED AS A GUIDE ONLY. LOCATIONS, MESSAGES, ADDITIONS AND DELETIONS OF SIGNS MAY BE VARIED AS DIRECTED BY THE TRAFFIC ENGINEER.
 2. ALL DIMENSIONS ARE IN INCHES UNLESS OTHERWISE NOTED IN THE PLANS OR IN THE DETAILS.

FIGURE T
TYPICAL CROSSROAD SIGNING
RURAL TRUMPET INTERCHANGE
4-5-1.0T

NOT TO SCALE

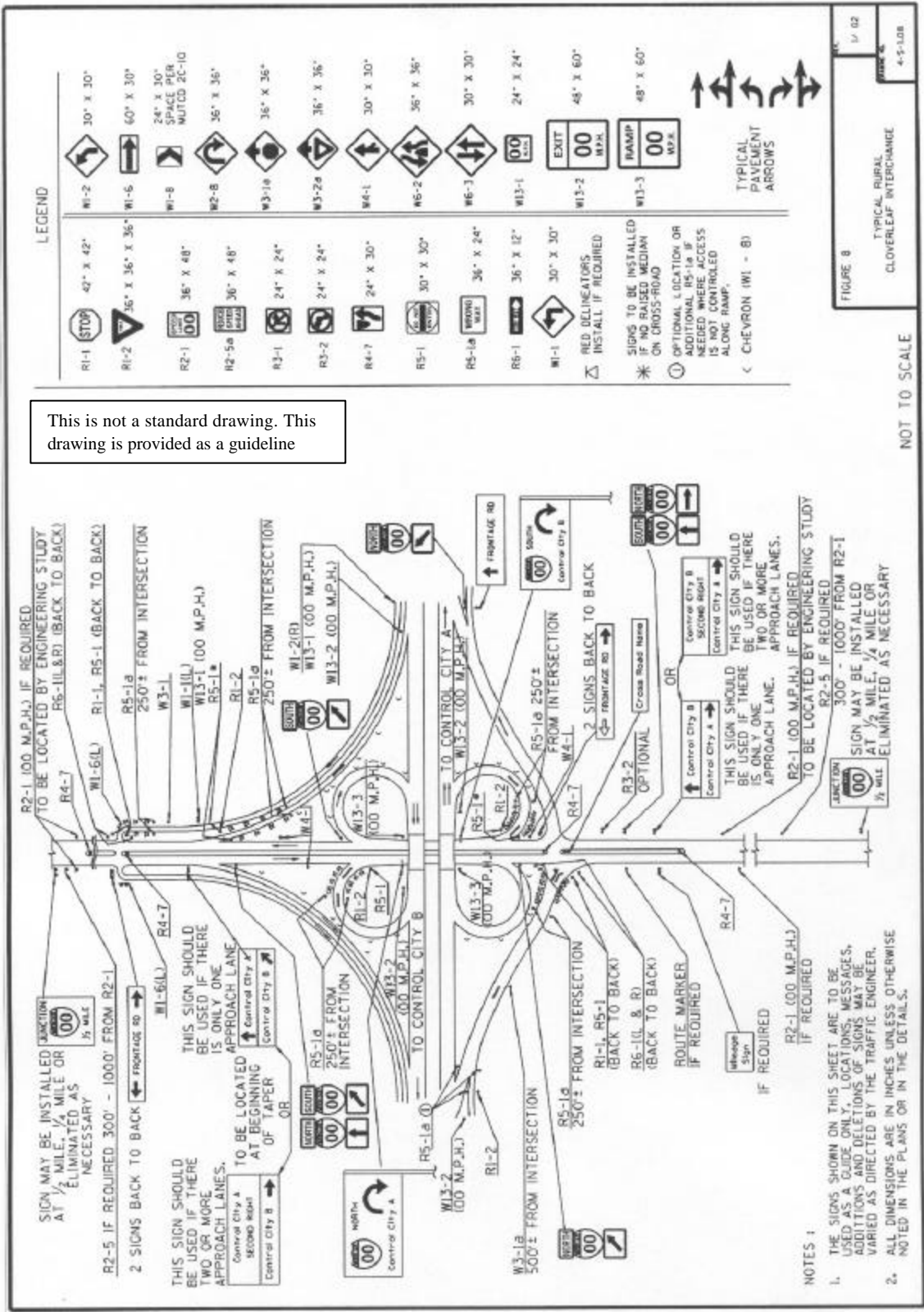

This is not a standard drawing. This drawing is provided as a guideline

This is not a standard drawing. This drawing is provided as a guideline

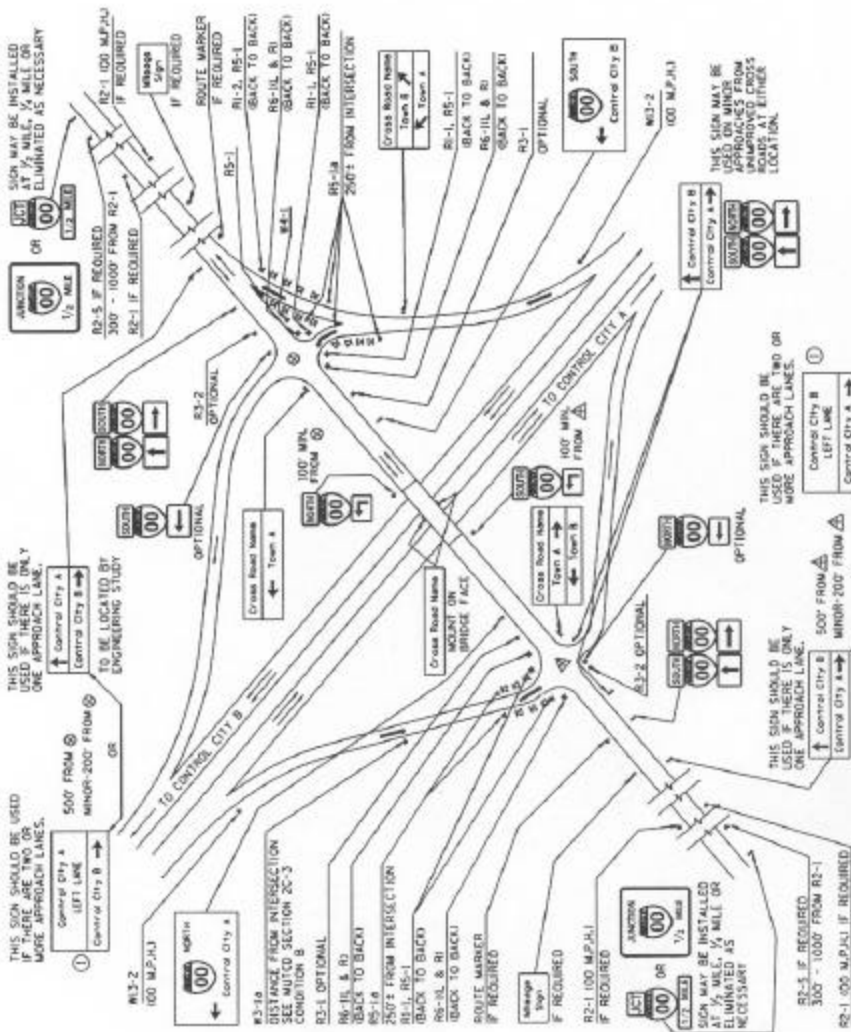
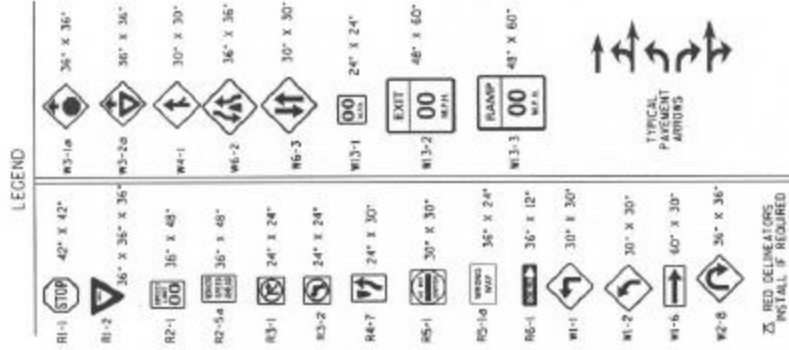

NOTES :

1. THE SIGNS SHOWN ON THIS SHEET TO BE USED AS A GUIDE ONLY. LOCATIONS, BEING AS DIRECTED BY THE TRAFFIC ENGINEER, VARIED AS DIRECTED BY THE TRAFFIC ENGINEER.
2. ALL DIMENSIONS ARE IN INCHES UNLESS OTHERWISE NOTED IN THE PLANS OR IN THE DETAILS.

FIGURE 3
TYPICAL RURAL
DIAMOND INTERCHANGE

NOT TO SCALE

4-5-109

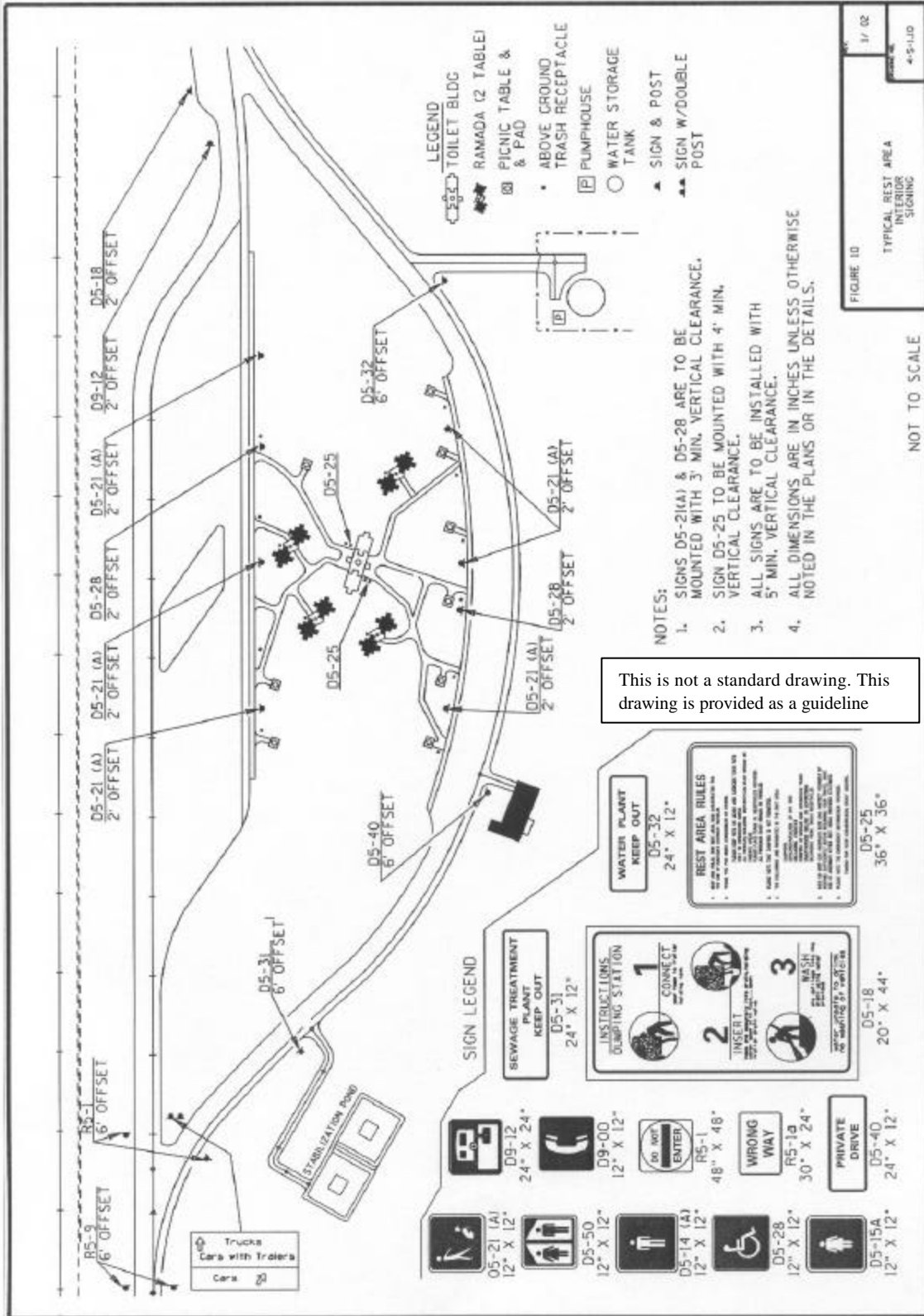

This is not a standard drawing. This drawing is provided as a guideline

This is not a standard drawing. This drawing is provided as a guideline

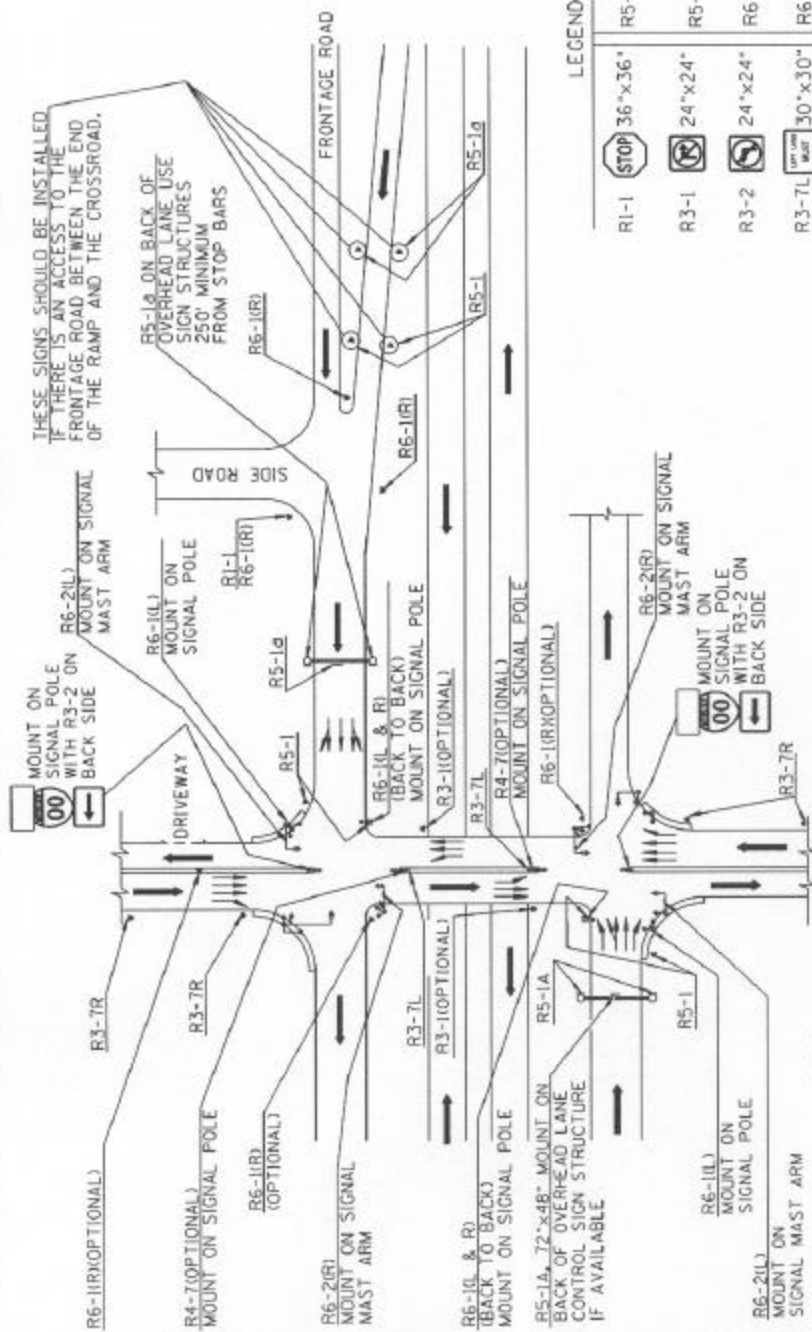

LEGEND

R1-1	STOP	36"x36"	R5-1	DO NOT ENTER	30"x30"
R3-1	NO LEFT TURN	24"x24"	R5-1a	WORKING TRAFFIC	36"x24"
R3-2	NO RIGHT TURN	24"x24"	R6-1	ONE WAY	36"x12"
R3-7L	LEFT TURN MUST YIELD TO PEDESTRIANS	30"x30"	R6-2	ONE WAY	30"x36"
R4-7	RIGHT TURN MUST YIELD TO PEDESTRIANS	24"x30"			

NOTES:

1. MOUNT SIGNS ON EXISTING LUMINAIRE AND SIGNAL POLES AND BACK TO BACK WHERE FEASIBLE.
2. WHERE ROADWAY CONDITIONS DO NOT PERMIT THE USE OF THIS STANDARD, ALTERNATE TREATMENT TO BE BASED ON ENGINEERING JUDGMENT.
3. LANE-USE CONTROL SIGNS (R3-5 TO R3-8) OMITTED FOR CLARITY. HOWEVER, THESE SIGNS SHALL BE INSTALLED PER THE MANUAL ON UNIFORM TRAFFIC CONTROL DEVICES, SECTION 2B-17 AND 2B-18.
4. ALL DIMENSIONS ARE IN INCHES UNLESS OTHERWISE NOTED IN THE PLANS OR IN THE DETAILS.

FIGURE 12
TYPICAL INTERCHANGE
REGULAR SIDE SIKING
SIGNALIZED NARROW MEDIAN

NOT TO SCALE

This is not a standard drawing. This drawing is provided as a guideline

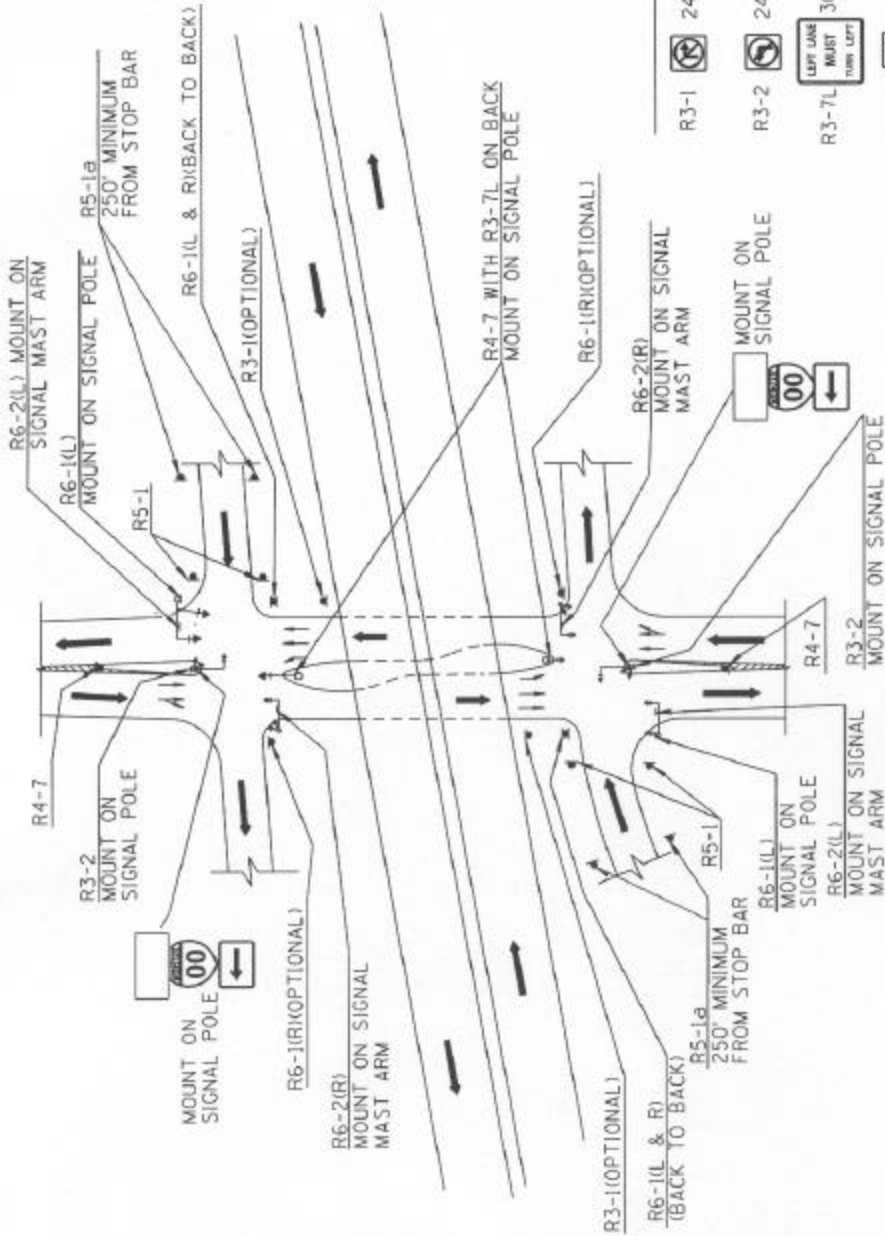

LEGEND

R3-1	24"x24"	30"x30"
R3-2	24"x24"	36"x24"
R3-7L	30"x30"	36"x12"
R4-7	24"x30"	30"x36"
R5-1		
R5-1a		
R6-1		
R6-2		

FIGURE 13
 TYPICAL INTERCHANGE
 REGULATORY SIGNING
 SIGNALIZED - WIDE MEDIUM

NOT TO SCALE

NOTE:
 1. ALL DIMENSIONS ARE IN INCHES UNLESS OTHERWISE NOTED IN THE PLANS OR IN THE DETAILS.

This is not a standard drawing. This drawing is provided as a guideline

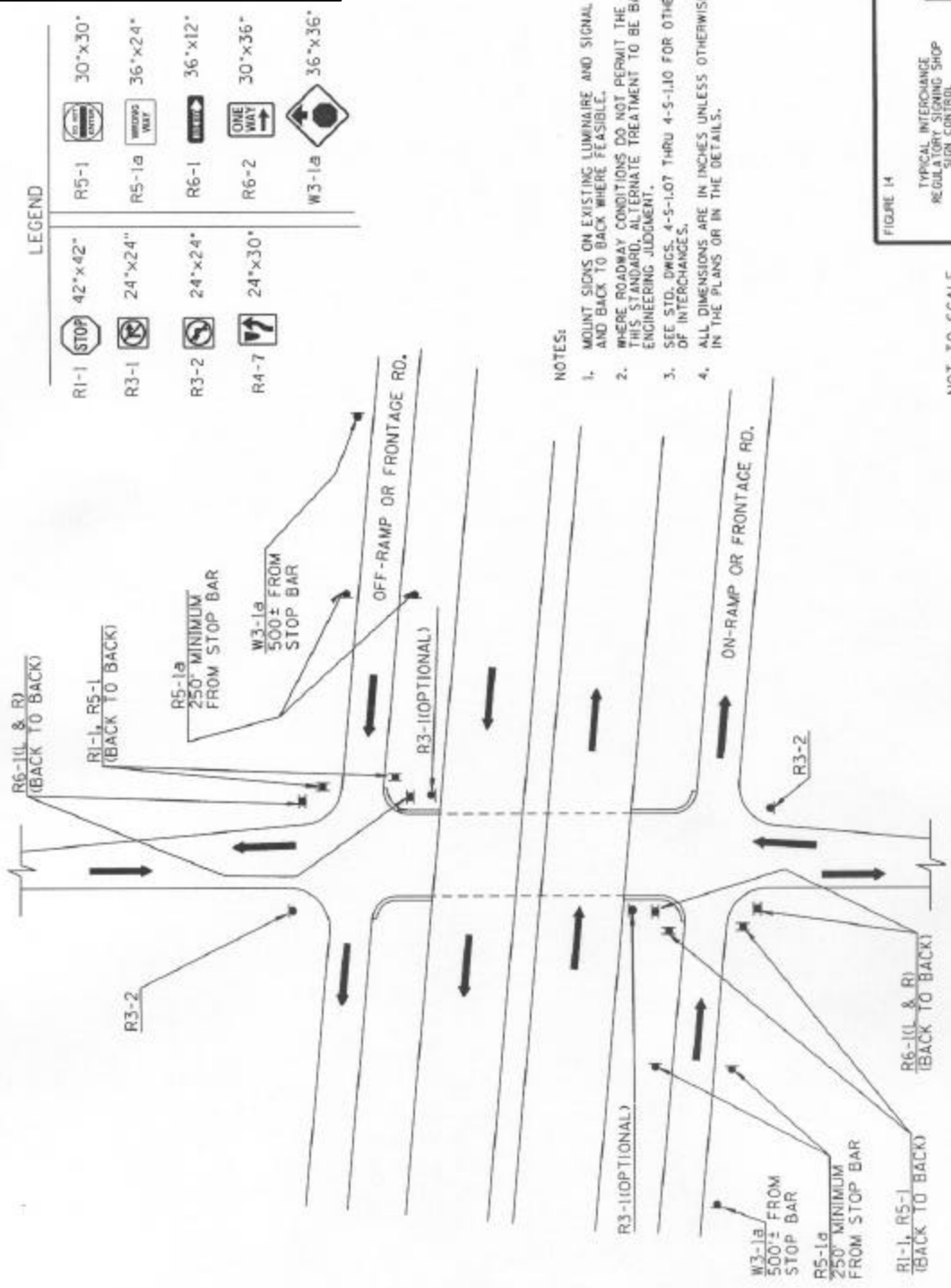
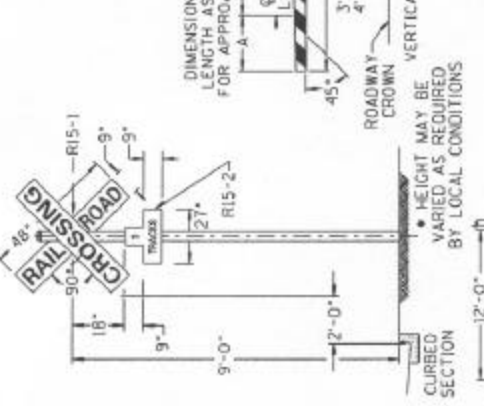
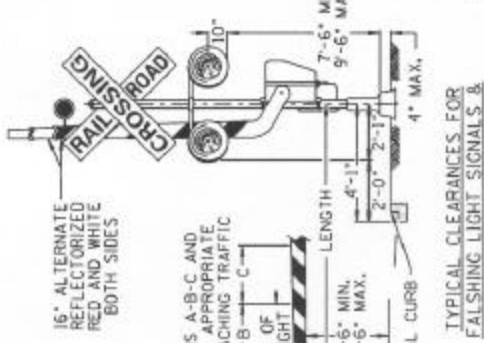
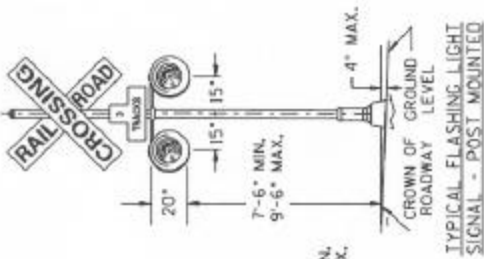
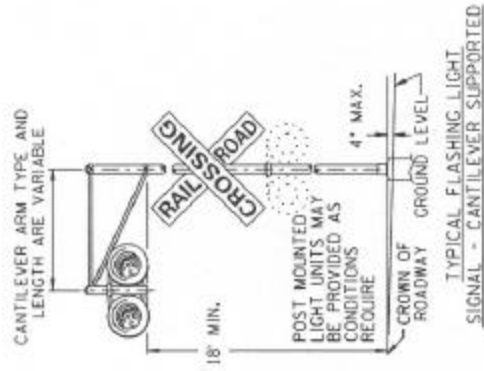

FIGURE 14
TYPICAL INTERCHANGING REGULATORY SIGNING SHOP
SIGN CONTROL
4-5-14

NOT TO SCALE

This is not a standard drawing. This drawing is provided as a guideline



NOTES:

1. ALL SIGNS TO BE REFLECTORIZED.
2. NO SIGNS ARE TO BE LOCATED IN THE CENTER OF UNDIVIDED ROADWAYS EXCEPT ON ISLANDS WITH BARRIER CURB.
3. ADDITIONAL W10-1 SIGNS MAY BE REQUIRED IN URBAN AREAS IF THERE ARE INTERSECTING STREETS WITHIN 100 FEET OF THE GRADE CROSSING.
4. MULTIPLE TRACKS GREATER THAN 100 FEET MAY REQUIRE ADDITIONAL SIGNING AND/OR TRAFFIC CONTROL DEVICES.
5. EQUIPMENT HOUSING (CONTROLLER CABINETS) SHOULD HAVE A MINIMUM LATERAL CLEARANCE OF 30 FEET FROM THE ROADWAY WHEREVER POSSIBLE.
6. SEE STD. DWG. 4-M-1.11 FOR TYPICAL PAVEMENT MARKINGS AT GRADE CROSSINGS.
7. REFER TO MANUAL ON UNIFORM TRAFFIC CONTROL DEVICES FOR ADDITIONAL INFORMATION.
8. ALL DIMENSIONS ARE IN INCHES, EXCEPT AS NOTED.

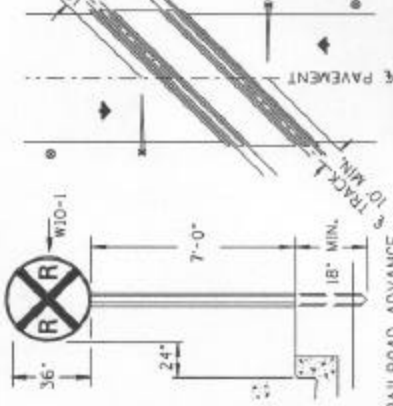
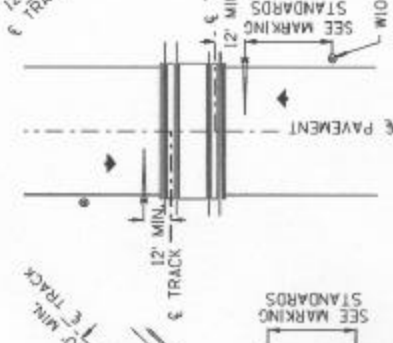
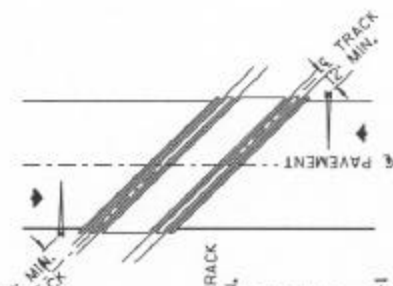
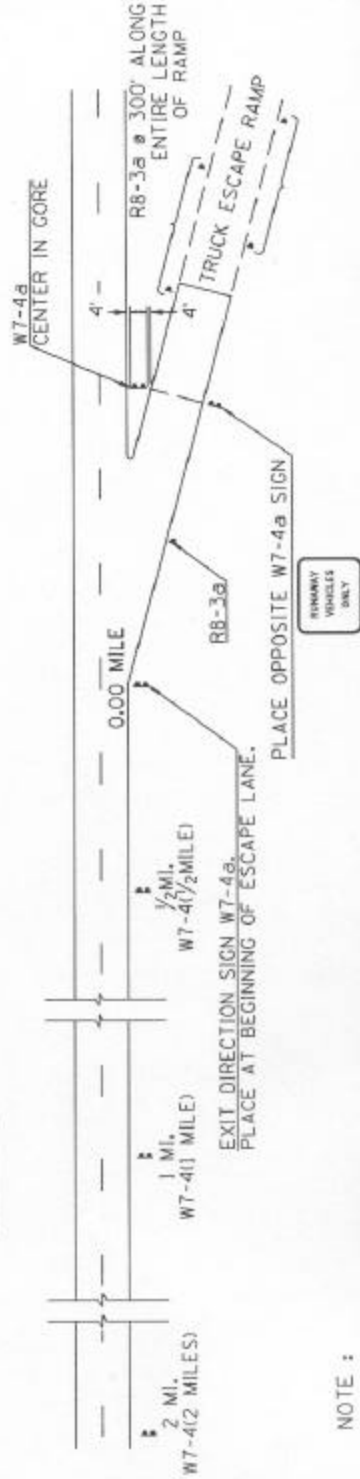

FIGURE 15
RAILROAD SIGNING
4-5-115

NOT TO SCALE

This is not a standard drawing. This drawing is provided as a guideline

LEGEND		FREEWAY	NON-FREEWAY
R8-3a		24" x 24"	24" x 24"
W7-4		108" x 84"	84" x 48"
W7-4a		120" x 84" 12" Copy	84" x 60" 6D Copy
		120" x 84"	60" x 48"



NOTE :
1. ALL DIMENSIONS ARE IN INCHES, EXCEPT AS NOTED.

FIGURE 16
TYPICAL SIGNING, TRUCK ESCAPE RAMP
4-5-01B

NOT TO SCALE